

Technical Data Sheet

CODE 16136

CA 250 MD E W

Centrifugal duct fans for wall mounting



Certifications



IMQ



CE



IMQ Performance



EAC



G-Mark

TECHNICAL AND PERFORMANCE DATA

Absorbed power 1st speed (W)	48	Delivery 1st speed (l/s)	138.8
Frequency (Hz)	50/60	Delivery 1st speed (m ³ /h)	500
Insulation Class	II ⁰	Max delivery at max speed (l/s)	286.1
IP	44	Max delivery at max speed (m ³ /h)	1030
Max absorbed Power at 60Hz (W)	175	Pressure - 1st speed (mmH2O)	34.9
Max ambient temperature for continuous operation (°C)	50	Pressure - 1st speed (Pa)	342.3
Max. absorbed Current at max. speed (A)	0,55	Pressure max - max speed (mmH2O)	55.9
Max. absorbed Current at min. speed (A)	0.48	Pressure max - max speed (Pa)	548.3
Max. absorbed power at max speed (W)	130	RPM max	2675
Nominal Diameter (mm)	250	RPM min	1340
Voltage (V)	220-240	Sound pressure level Lp [dB (A)] 3m - max speed	50.8
Weight (Kg)	6,2	Sound pressure level Lp [dB (A)] 3m - min speed	31.6

DIMENSIONS

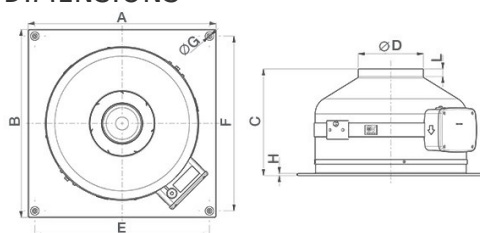

Size A (mm)	424
Size B (mm)	424
Size C (mm)	237
Size D (mm)	∅ 247
Size E (mm)	394
Size F (mm)	394
Size G (mm)	∅ 5
Size H (mm)	5
Size L (mm)	38
Size M (mm)	250

PER INFORMAZIONI:

Servizio al Cliente: tel +39 02 90699395 premendo 1 dopo messaggio registrato (consulenza su prodotti e impianti)

Pre & Post Vendita: fax +39 02 90699302

Email prevendita: prevendita@vortice-italy.com

Technical Data Sheet

CODE 16136

CA 250 MD E W

Centrifugal duct fans for wall mounting



DESCRIPTION

- Pickled and phosphated steel housing/roof mounting plate with polyester powder-coated finish, resistant to the aggressive action of atmospheric agents.
- Nominal diameter 250 mm.
- 3 speed fan through TRIO-CA optional control (cod. 12869), consisting of:
 - External rotor AC motor with thermal overload cutout and shaft turning in ball bearings,
 - backward curved impeller.
- Operation controllable by remote sensors monitoring: Temperature, Relative Humidity, Smoke and Presence.
- Zinc-coated steel brackets for wall mounting.

CURVES

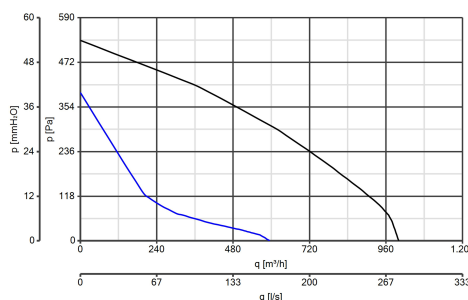
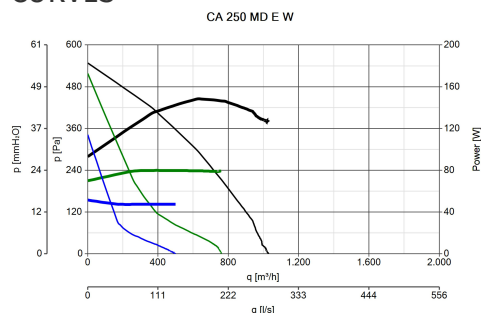

ACCESSORIES



TRIO-CA
Code 12869



**KIT SCB
(TRASF.E.C.)**
Code 22481



**CA-G 250
(GRIGLIA DI
PROTEZIONE)**
Code 22770



**C 1.5
(COMANDO EL.
1.5 A)**
Code 12966

PER INFORMAZIONI:

Servizio al Cliente: tel +39 02 90699395 premendo 1 dopo messaggio registrato (consulenza su prodotti e impianti)
Pre & Post Vendita: fax +39 02 90699302
Email prevendita: prevendita@vortice-italy.com